

DESENHO 1-1
LEGENDA

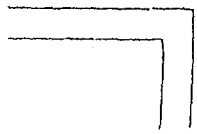

PROJEÇÃO DE ELEMENTOS CONSTRUTIVOS



PAREDES BAIXAS, MUROS, PEITORIS

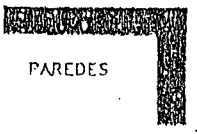

PAREDES



PLANTA DE
MASSA

À CONSTRUIR

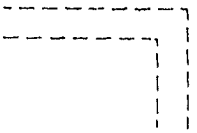

OU

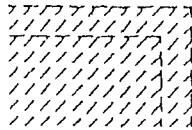

PAREDES OU PARTES
EXISTENTES À DEMOLIR

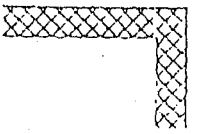

OU

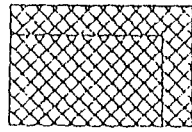

PAREDES OU PARTES
EXISTENTES À SEREM
REGULARIZADAS

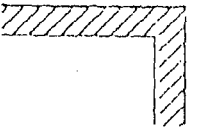

OU

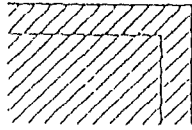

PAREDES OU PARTES
EXISTENTES REGULARES
À SEREM MANTIDAS

DESENHO 1-II

CONCEITOS

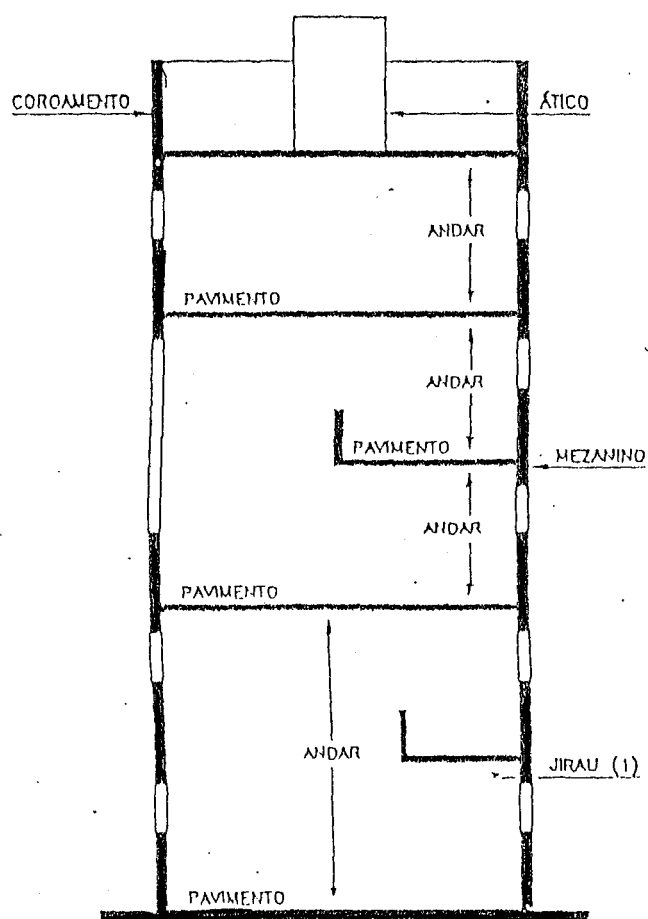

(1) O JIRAU NÃO SUBORDINA O ANDAR; OCUPANDO
NO MÁXIMO 30% DO PAVIMENTO COM ATÉ 30,00m²

DESENHO 9-1

EDIFICAÇÕES COM E SEM ELEVADORES

A) AS EDIFICAÇÕES QUE APRESENTEM AS CONDIÇÕES ABAIXO NÃO NECESSITAM DE ELEVADOR DE PASSAGEIROS

B) AS EDIFICAÇÕES QUE ULTRAPASSAREM O DISPOSTO NO "DESENHO A" NECESSITAM DE NO MÍNIMO UM ELEVADOR DE PASSAGEIROS

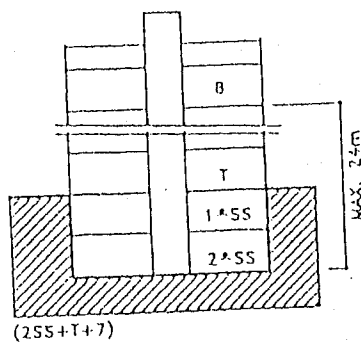
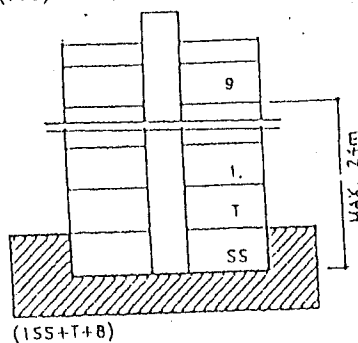
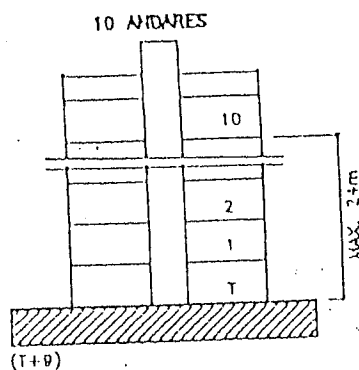
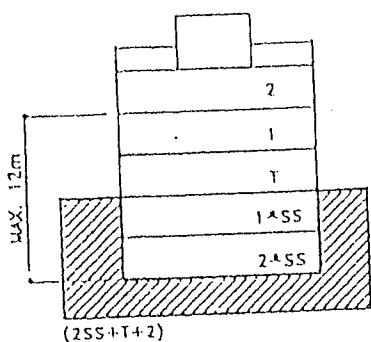
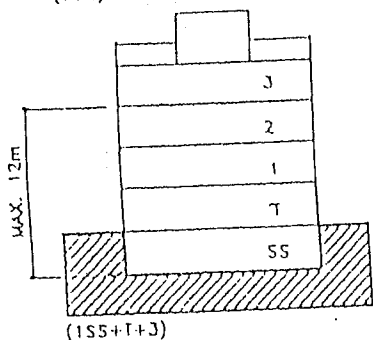
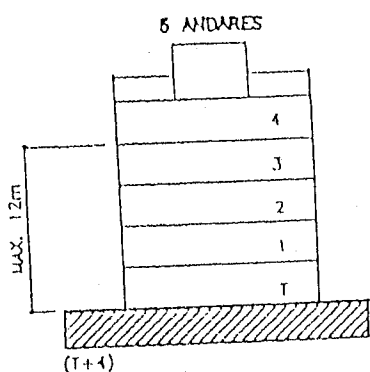

C) AS EDIFICAÇÕES QUE ULTRAPASSAREM AS CONDIÇÕES DO "DESENHO B" DEVEM DISPOR DE PELO MENOS DOIS ELEVADORES
OBS.: RESPEITADAS AS CONDIÇÕES DE CÁLCULO DE TRÁFEGO DA N.T.O.

DESENHO 9-II.a

CIRCULAÇÃO PRIVATIVA A HALL
DE ACESSO DE ELEVADOR

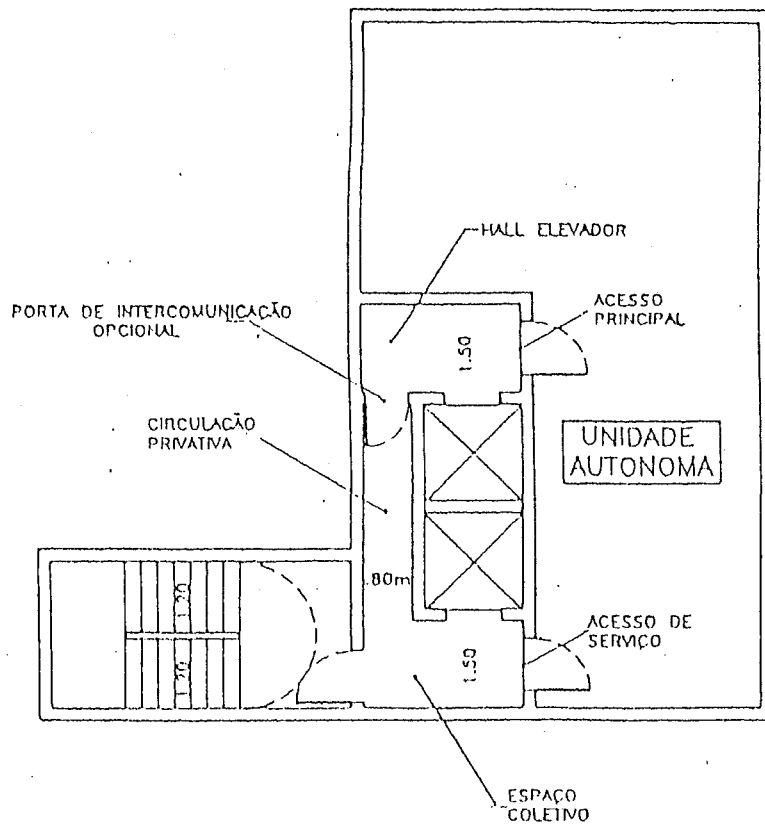

DESENHO 9-II.b

CIRCULAÇÃO PRIVATIVA A HALL
DE ACESSO DE ELEVADOR

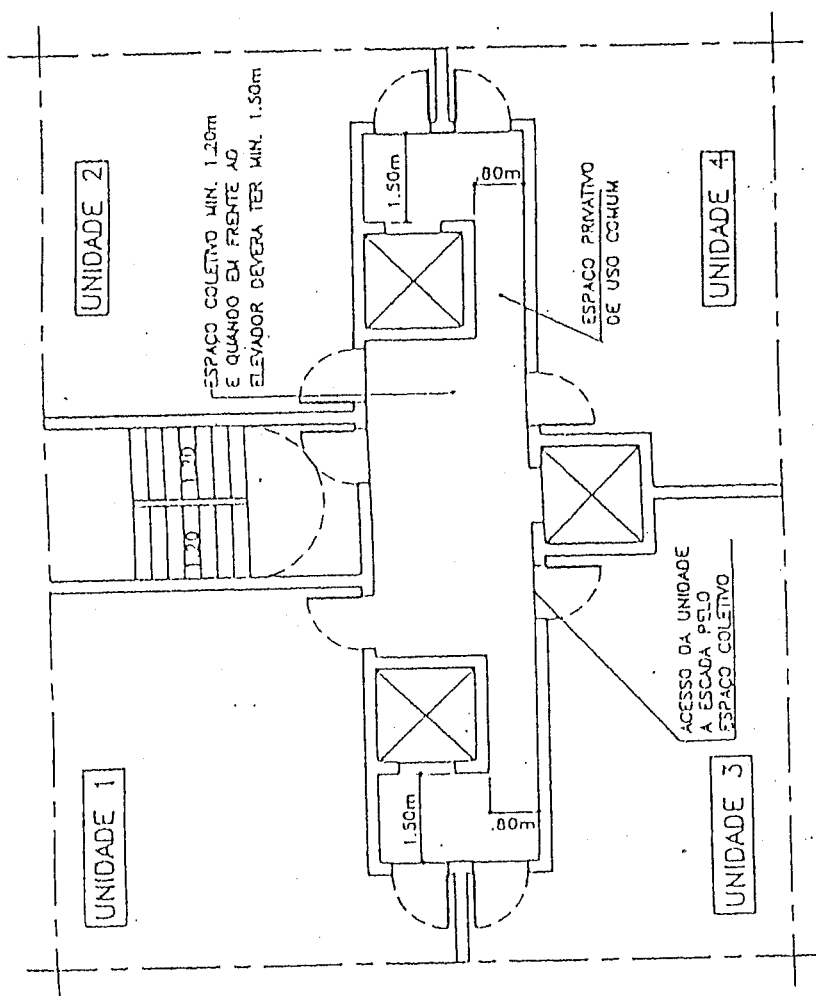

DESENHO 10-1

IMPLANTAÇÃO JUNTO ÀS DIVISAS

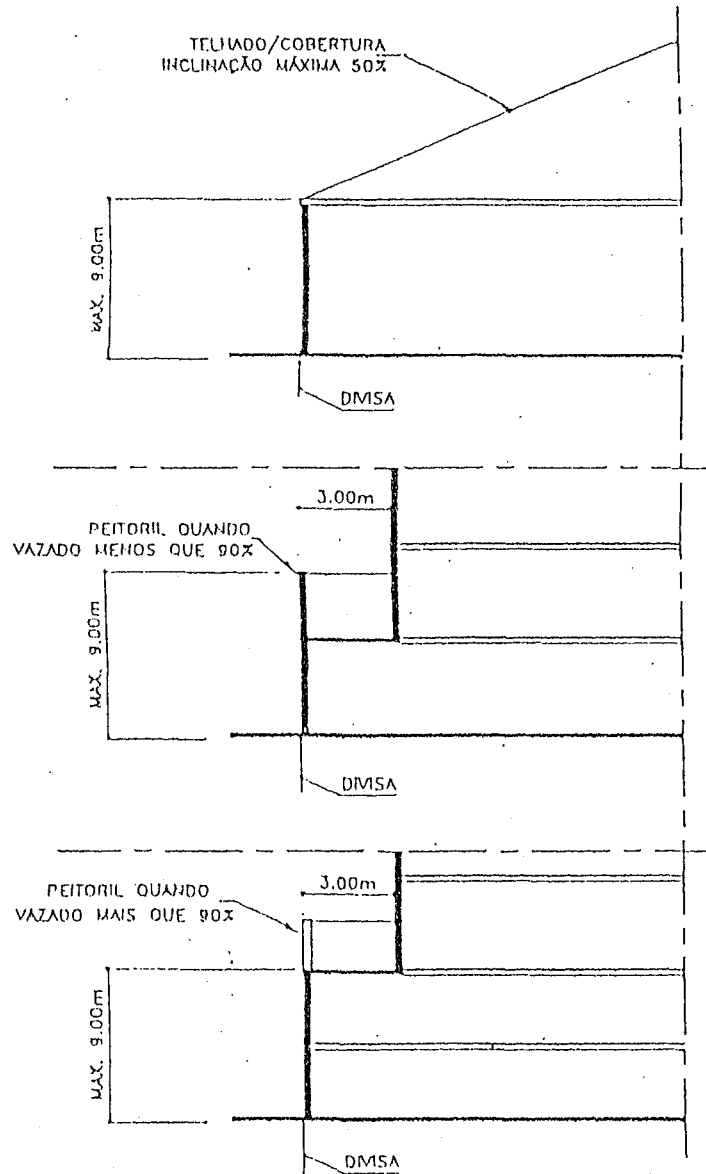

DESENHO 10-II.a

REENTRÂNCIA (1:1.5)

NO VOLUME INFERIOR "VI"

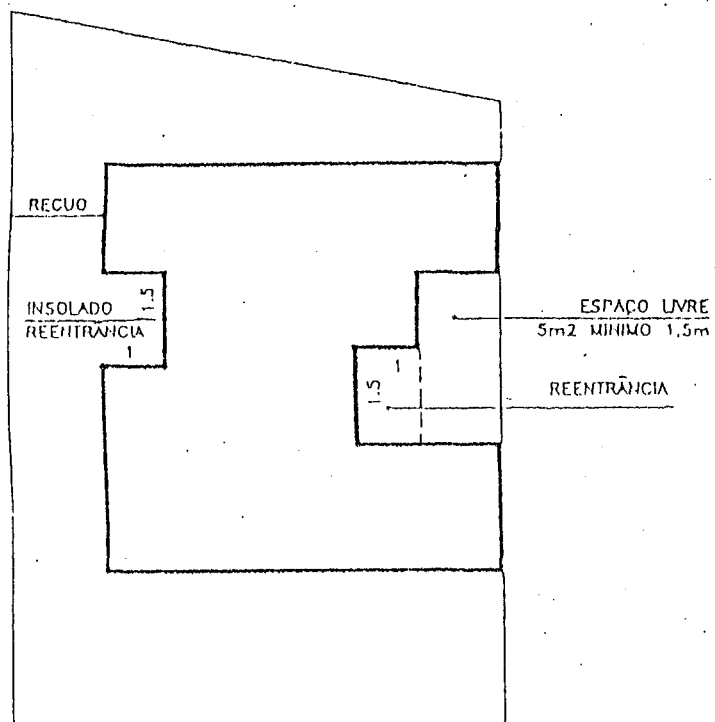

DESENHO 10-II.b
REENTRÂNCIA (1:1.5)
NO VOLUME SUPERIOR "VS"

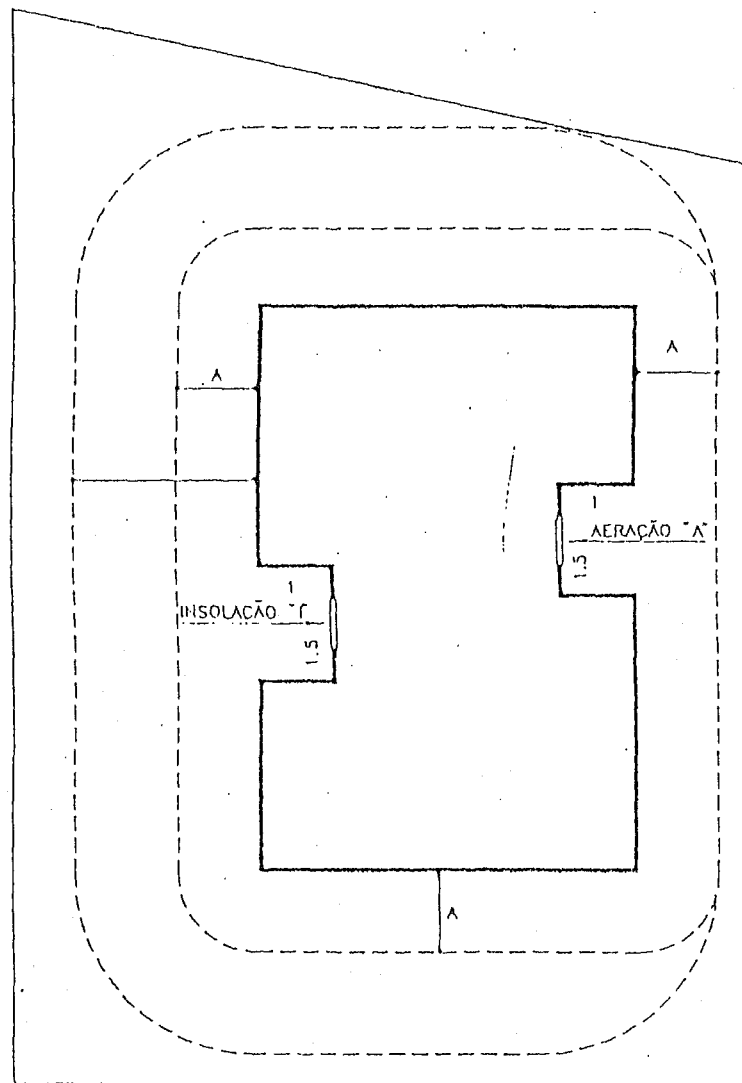

DESENHO 10-III.a

CLASSIFICAÇÃO DOS VOLUMES

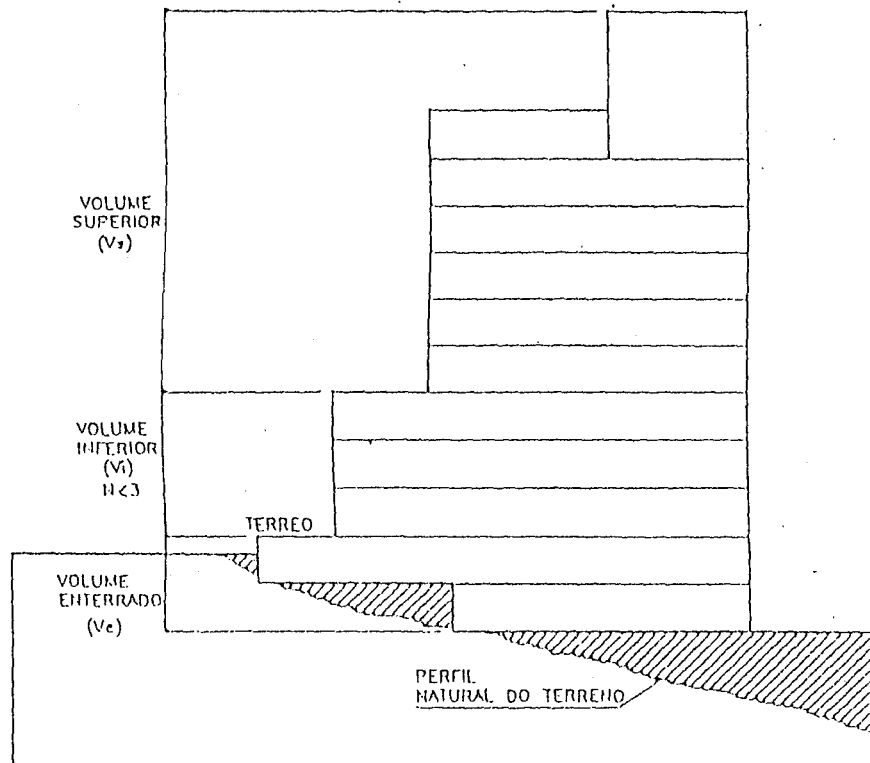

DESENHO 10-III.b

Σ "n"

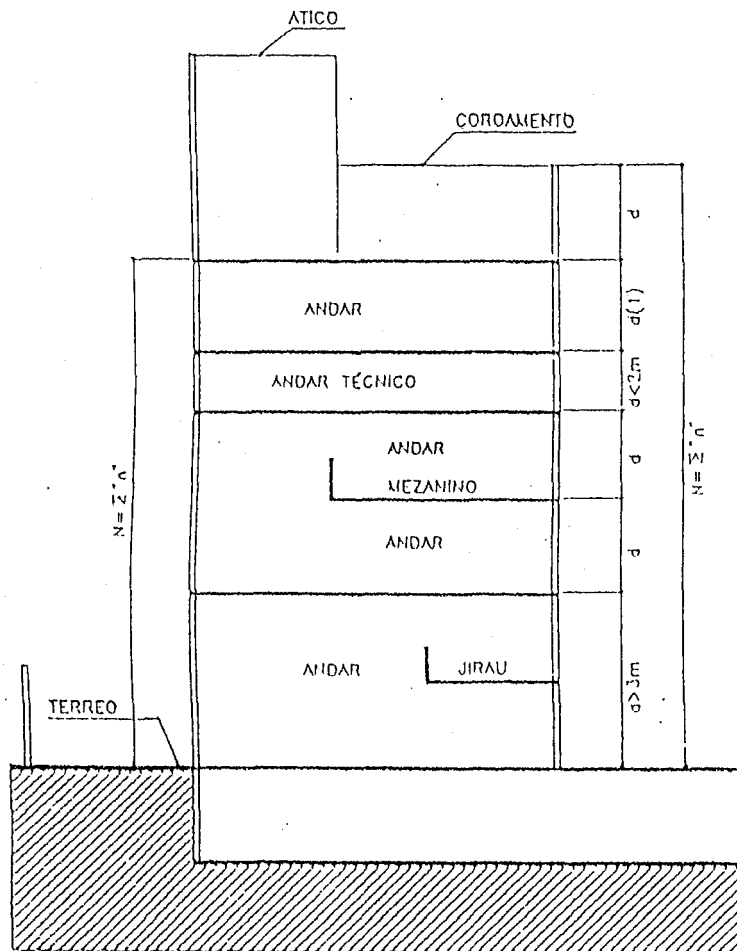

(1) QUANDO SE TRATAR DE ANDAR ÚNICO
OU DE COBERTURA, O DESNIVEL "d"
SERÁ O PÉ DIREITO DO ANDAR

OBS.: CONFORME O DESNIVEL "d" OBTÉM-SE O "n" ATRAVÉS DE:

- PARA $2.00m \leq d \leq 3.00m \rightarrow n=1$
- PARA $d < 2.00m \rightarrow n=1+1/3(d-2)$
- PARA $d > 3.00m \rightarrow n=1+1/3(d-3)$

DESENHO 10-III.c

PAVIMENTO EM DESNIVEL

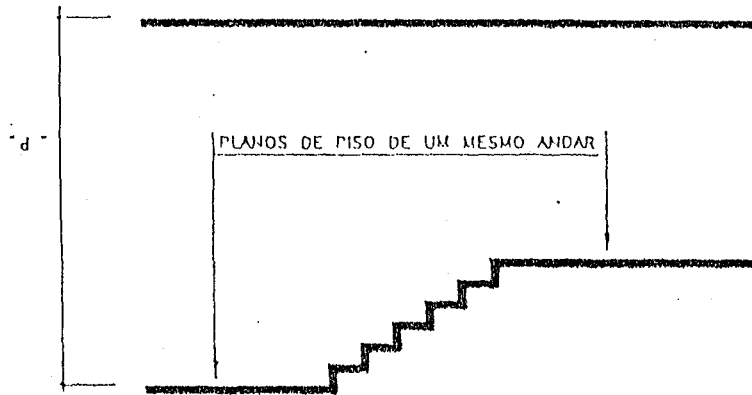

DESNIVEL "d" A CONSIDERAR PARA CÁLCULO DO ÍNDICE VOLUMÉTRICO "n" DO ANDAR

DESENHO 10-III.d

DESNIVEL "d"

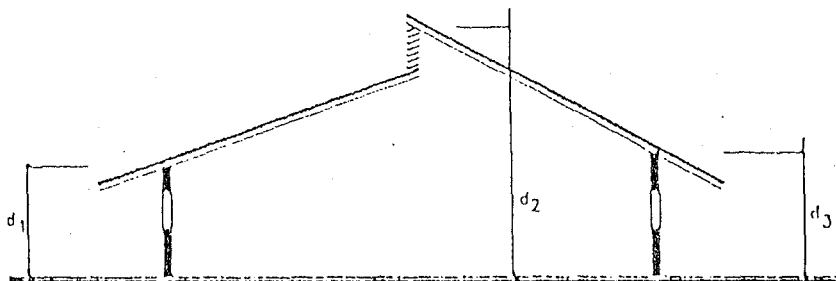

- QUANDO O PISO OU O TETO FOREM INCLINADOS, O DESNIVEL "d" CONSIDERADO SERÁ A ALTURA MÉDIA DO ANDAR

$$d = \frac{d_1 + d_2 + d_3}{3} \quad \text{OU}$$

$$d = \frac{d_1 + d_2 + \dots + d_n}{n}$$

DESENHO 10-IV

ESPAÇOS LIVRES NOS VOLUMES "Vi" E "Ve"

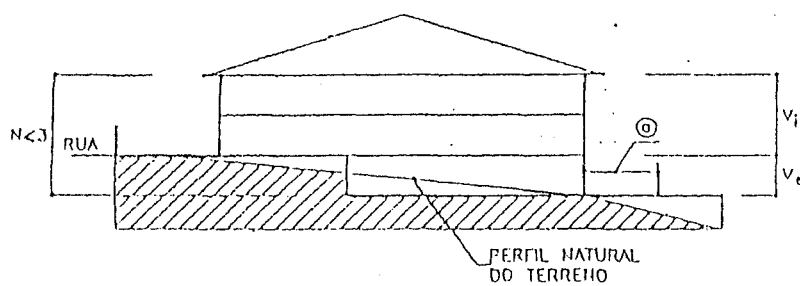

- ⊙ - RECUÓS DA LUZOS . E
- ESPAÇOS INTERIROS DO LOTE COM AREA MINIMA DE 5.00m² E LARGURA MINIMA DE 1.50m

DESENHO 10-VI.d
 FAIXA LIVRE "I"

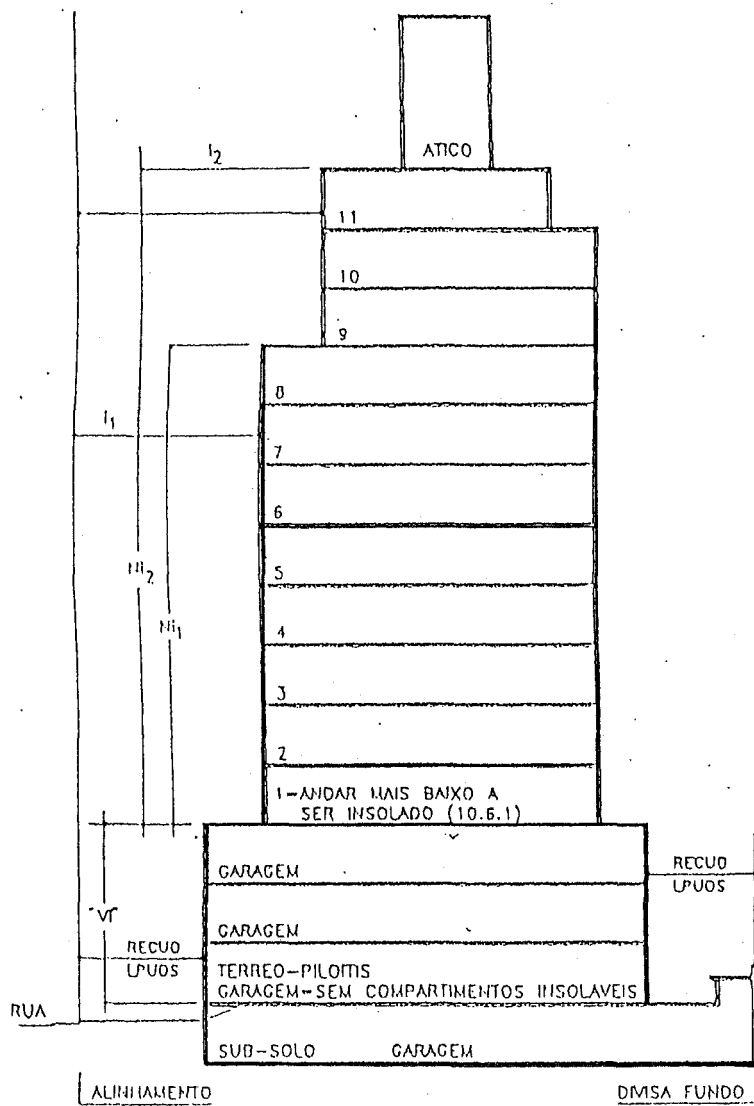

DESENHO 10-VI.b

ESPAÇO LIVRE "Y"

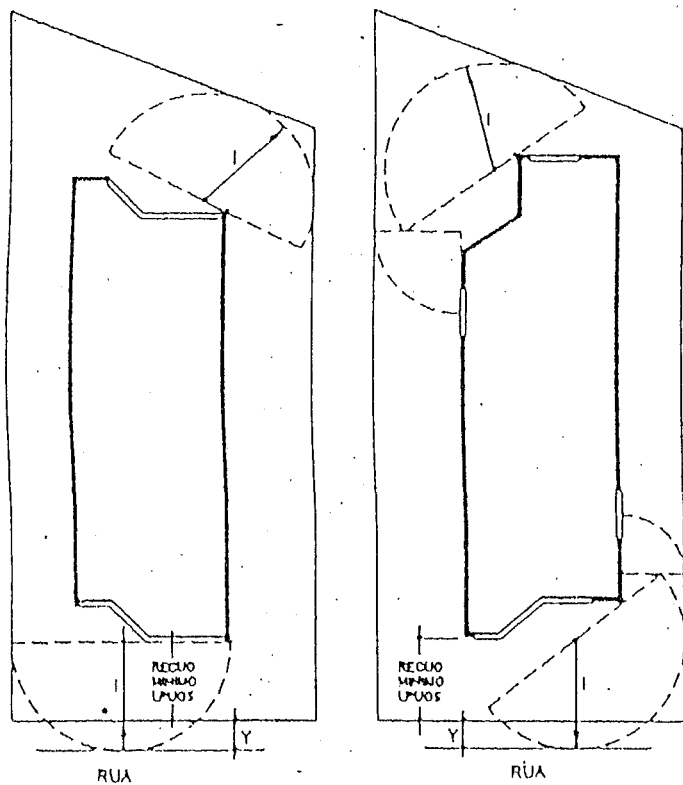

$Y < 20 \times "f"$
 $Y < 1/3 \text{ DA RUA}$

DESENHO 10-VI.c
ESPAÇO LIVRE "I"
FAIXA LIVRE "A"
REBATIMENTOS

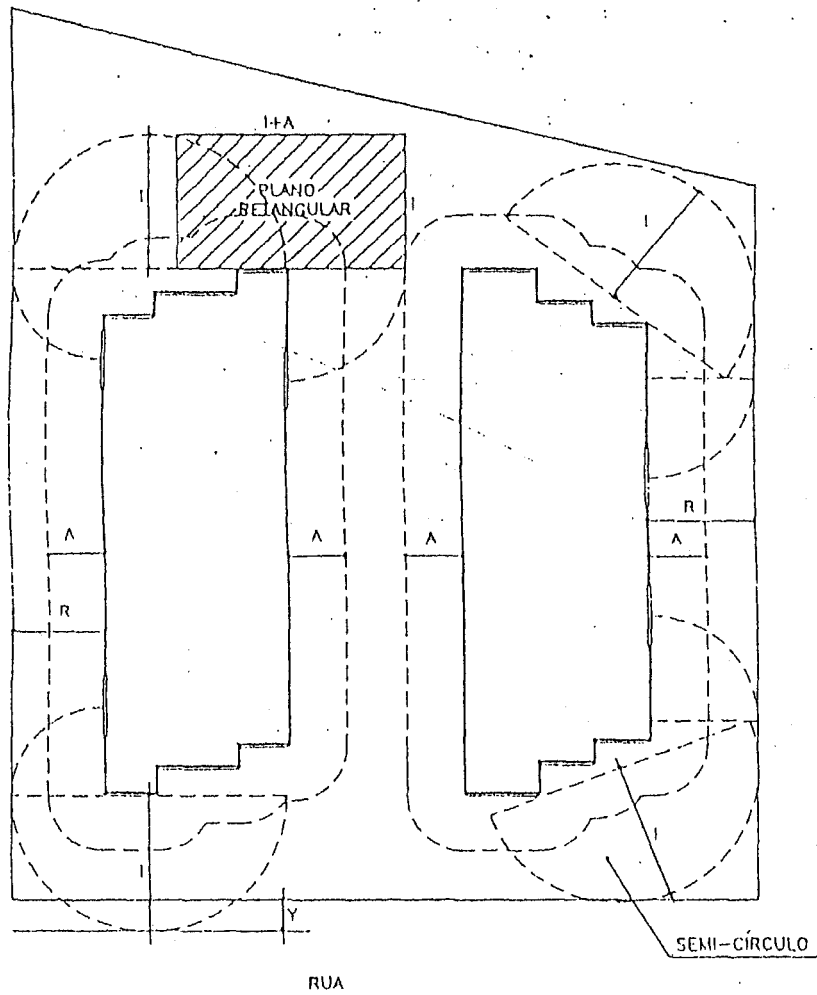

DESENHO 10-VI.d
AREA LIVRE INTERNA

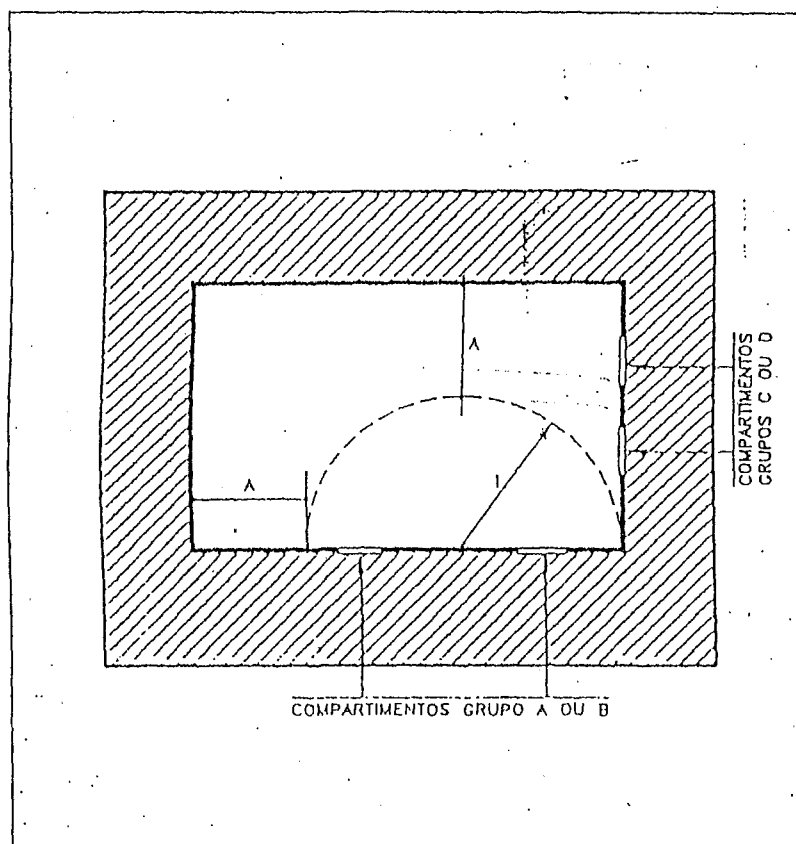

DESENHO 10-VII
AJUSTE FAIXA "A" E ESPAÇO "I"

